

Type: Submersible mixer
 Application: Prevent the accumulation of solids and floating crusts.

Mixer

Effective area up to Ø16m
 Impeller diameter 160
 Electrical power in clean water 8.6 kW
 Weight 87 kg

Motor

Mains: 50Hz – 3 phase
 Rated shaft power (P2) 7.5 kW
 Absorbed electrical power (P1) 9.3 kW
 Nominal speed 1390 rpm
 Motor efficiency 78 %
 Power factor (cos phi) 0.88
 Degree of protection IP 68
 Isolation class F (155°C)
 Max. water temperature 40°C
 Standard cable length 10 m

Materials

Impeller	AISI 329
Motor unit parts	AISI 329
Pump shaft	AISI 316
Pump support	AISI 316
Bolts	AISI 316
Rubber parts	Viton (FPM)
Electrical cable	Neoprene (CR)
Seal lubrication	Oil
Seal pump side	Silicon carbide – silicon carbide-Viton
Seal motor side	Carbon - ceramic

Optional

- Flameproof version, to class:
 Standard: II 2 G Ex b c d IIB T4 Gb
 With Frequency control: II 2 G Ex b c d IIB T3 Gb
- Thermoswitches in motor windings
 (standard for flameproof version)
- Cable protection sheet (AISI316)
- Water detector in motor and oil chamber
 Flameproof version with external cable

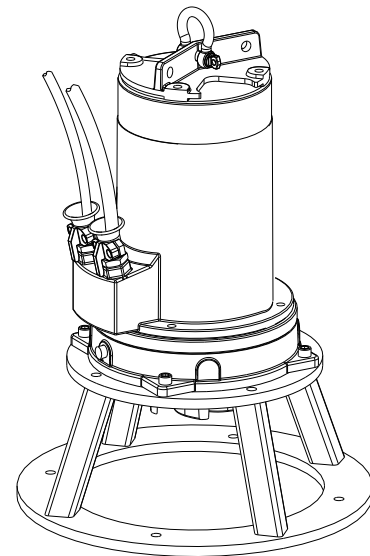

Dimensions mm

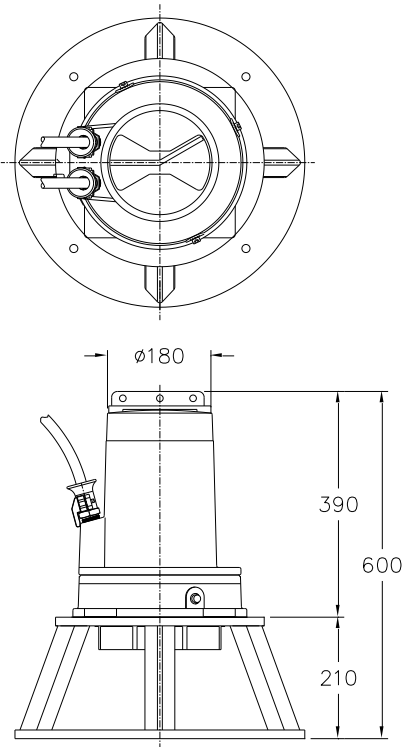

Connections

		electrical cable size		motor protection and/or water detector		flameproof version	
voltage	current	directe start	ster-driehoek start	directe start	ster-driehoek start	directe start	ster-driehoek start
[V]*	[A]						
230	26.4	4G6	7G2.5	4G6 + 4G1.5	7G2.5 + 4G1.5	4G6 + 4G2.5	7G2.5 + 4G2.5
400	15.2	4G2.5	7G1.5	7G1.5	10G1.5	7G1.5	10G1.5
500	12.1	4G2.5	7G1.5	7G1.5	10G1.5	7G1.5	10G1.5
starting current DOL start : 6.1 x rated current							
starting current YD start : 2.0 x rated current							* other voltages on request